



LUMINAIRE TESTING LABORATORY, INC.

SUSTAINING
MEMBER
of the
IESNA

905 Harrison Street · Allentown, PA 18103 · 610-770-1044 · Fax 610-770-8912 · www.LuminaireTesting.com

LTL NUMBER: 13214

DATE: 08-04-2008

PREPARED FOR: EB FLUORESCENT COMPANY, INC.

CATALOG NUMBER: RDI 2X2 3/17

LUMINAIRE: FORMED WHITE ENAMEL STEEL HOUSING, FORMED WHITE ENAMEL STEEL REFLECTOR, FORMED WHITE ENAMEL PERFORATED STEEL SHIELD WITH TRANSLUCENT WHITE PLASTIC INSERT.

LAMPS: THREE 17 WATT T8 LINEAR FLUORESCENT LAMPS RATED AT 1325 LUMENS EACH.

LAMP CATALOG NUMBER: GE F17T8/SP41/ECO

BALLAST: ONE UNIVERSAL LIGHTING TECHNOLOGIES B332IUNVHP-A

MOUNTING: RECESSED

TOTAL INPUT WATTS = 42.2 AT 120.0 VOLTS

THE 0 DEGREE PLANE IS PARALLEL WITH THE LAMPS.

CANDELA DISTRIBUTION

	0.0	22.5	45.0	67.5	90.0
0	585	585	585	585	585
5	582	582	582	583	582
15	559	560	562	564	565
25	513	516	522	529	531
35	446	452	464	476	481
45	360	370	390	408	416
55	258	274	303	332	343
65	149	171	213	242	252
75	58	79	111	136	143
85	9	13	23	31	34
90	0	0	0	0	0

FLUX

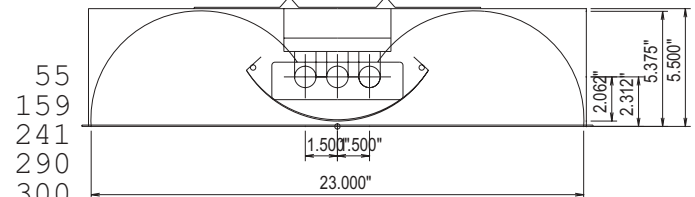

ZONAL LUMEN SUMMARY

ZONE	LUMENS	%LAMP	%FIXT
0- 30	455	11.4	27.4
0- 40	746	18.8	44.9
0- 60	1316	33.1	79.3
0- 90	1659	41.7	100.0
90-180	0	0.0	0.0
0-180	1659	41.7	100.0

TOTAL LUMINAIRE EFFICIENCY: 41.7%
 TOTAL REFLECTANCE OF PAINT: 79.1%
 CIE TYPE: DIRECT

PLANE: 0-DEG 90-DEG
 SPACING CRITERIA: 1.2 1.3
 LUMINOUS LENGTH: 23.125 23.125

LUMINANCE IN CANDELA PER SQUARE METER

ANGLE IN DEG	AVERAGE 0-DEG	AVERAGE 45-DEG	AVERAGE 90-DEG
0	1695.	1695.	1695.
45	1476.	1599.	1705.
55	1304.	1531.	1733.
65	1022.	1461.	1728.
75	649.	1243.	1601.
85	299.	765.	1131.

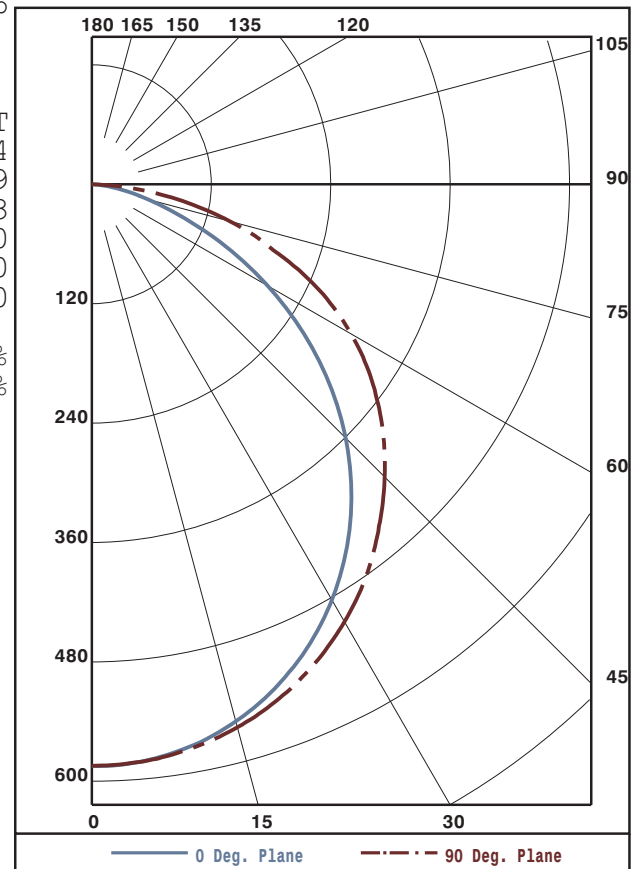

Approved By: MG



LUMINAIRE TESTING LABORATORY, INC.

SUSTAINING MEMBER of the IESNA

905 Harrison Street · Allentown, PA 18103 · 610-770-1044 · Fax 610-770-8912 · www.LuminaireTesting.com

LTL NUMBER: 13214

DATE: 08-04-2008

PREPARED FOR: EB FLUORESCENT COMPANY, INC.

COEFFICIENTS OF UTILIZATION - ZONAL CAVITY METHOD
EFFECTIVE FLOOR CAVITY REFLECTANCE 0.20

Table with 19 columns (RC, RW, and 18 numerical values) and 11 rows (0-10).

CANDELA DISTRIBUTION

Table with 6 columns (0, 5, 10, 15, 20, 25, 30, 35, 40, 45, 50, 55, 60, 65, 70, 75, 80, 85, 90) and 18 rows.

ZONAL LUMEN SUMMARY

Table with 2 columns (0-5, 5-10, 10-15, 15-20, 20-25, 25-30, 30-35, 35-40, 40-45, 45-50, 50-55, 55-60, 60-65, 65-70, 70-75, 75-80, 80-85, 85-90) and 17 rows.

THIS TEST WAS CONDUCTED USING RELATIVE PHOTOMETRY TECHNIQUES ACCORDING TO STANDARD IESNA PROCEDURES. THE USER MUST THEREFORE USE CAUTION IN THE FOLLOWING SITUATIONS: 1) THIS TEST WAS PERFORMED USING A SPECIFIC BALLAST/LAMP COMBINATION. EXTRAPOLATION OF THESE DATA FOR OTHER BALLAST/LAMP COMBINATIONS MAY PRODUCE ERRONEOUS RESULTS. 2) ACCORDING TO IESNA PROCEDURES, THE BALLAST(S) AND LAMP(S) ARE PRESUMED TO PRODUCE 100% OF RATED OUTPUT. AN APPROPRIATE BALLAST FACTOR MUST BE APPLIED TO THE LUMEN OUTPUT RATINGS AND LUMINOUS INTENSITY VALUES GIVEN. 3) THIS TEST WAS CONDUCTED IN A CONTROLLED LABORATORY ENVIRONMENT WHERE THE AMBIENT TEMPERATURE WAS HELD AT 25°C ±1°C. FIELD PERFORMANCE MAY DIFFER PARTICULARLY IN REGARDS TO CHANGE IN LUMINOUS OUTPUT AS A RESULT OF DIFFERENCE IN AMBIENT TEMPERATURE AND METHOD OF MOUNTING THE LUMINAIRE.