



LUMINAIRE TESTING LABORATORY, INC.

SUSTAINING
MEMBER
of the
IESNA

905 Harrison Street · Allentown, PA 18103 · 610-770-1044 · Fax 610-770-8912 · www.LuminaireTesting.com

LTL NUMBER: 13199

DATE: 08-04-2008

PREPARED FOR: EB FLUORESCENT COMPANY, INC.

CATALOG NUMBER: 78N 2/32

LUMINAIRE: FORMED WHITE ENAMEL STEEL HOUSING/REFLECTOR, CLEAR
PRISMATIC PLASTIC LENS WITH LINEAR PRISMATIC SIDES.

LAMPS: TWO 32 WATT T8 LINEAR FLUORESCENT LAMPS RATED AT 2850 LUMENS
EACH.

LAMP CATALOG NUMBER: PHILIPS F32T8/TL841/ALTO

BALLAST: ONE ADVANCE ICN-2P32-SC

MOUNTING: SURFACE

TOTAL INPUT WATTS = 57.2 AT 120.0 VOLTS

THE 0 DEGREE PLANE IS PARALLEL WITH THE LAMPS.

#13199

CANDELA DISTRIBUTION

	0.0	22.5	45.0	67.5	90.0
0	1387	1387	1387	1387	1387
5	1382	1382	1383	1386	1388
15	1337	1345	1361	1376	1382
25	1247	1268	1302	1326	1333
35	1108	1139	1172	1173	1170
45	896	908	885	858	845
55	508	525	518	504	490
65	245	276	322	326	327
75	133	159	221	284	303
85	47	69	151	201	209
90	0	26	106	133	137
95	0	29	88	97	99
105	0	26	40	41	41
115	1	21	44	57	59
125	3	21	41	51	53
135	4	19	35	43	45
145	4	14	26	34	37
155	3	9	18	23	24
165	3	5	9	12	14
175	3	3	3	4	5
180	3	3	3	3	3

FLUX

132
385
598
721
676
463
303
232
148

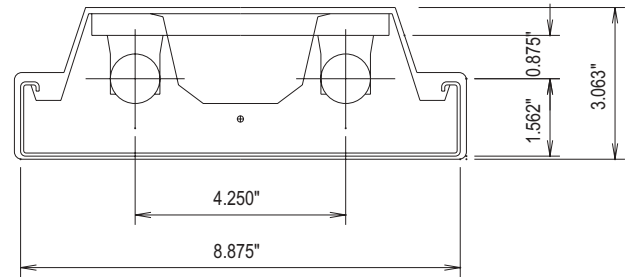

ZONAL LUMEN SUMMARY

ZONE	LUMENS	%LAMP	%FIXT
0- 30	1115	19.6	28.7
0- 40	1836	32.2	47.3
0- 60	2975	52.2	76.6
0- 90	3660	64.2	94.2
90-120	144	2.5	3.7
90-130	176	3.1	4.5
90-150	214	3.8	5.5
90-180	225	3.9	5.8
0-180	3884	68.1	100.0

TOTAL LUMINAIRE EFFICIENCY: 68.1%
TOTAL REFLECTANCE OF PAINT: 84.6%
CIE TYPE: DIRECT
PLANE: 0-DEG 90-DEG
SPACING CRITERIA: 1.3 1.3

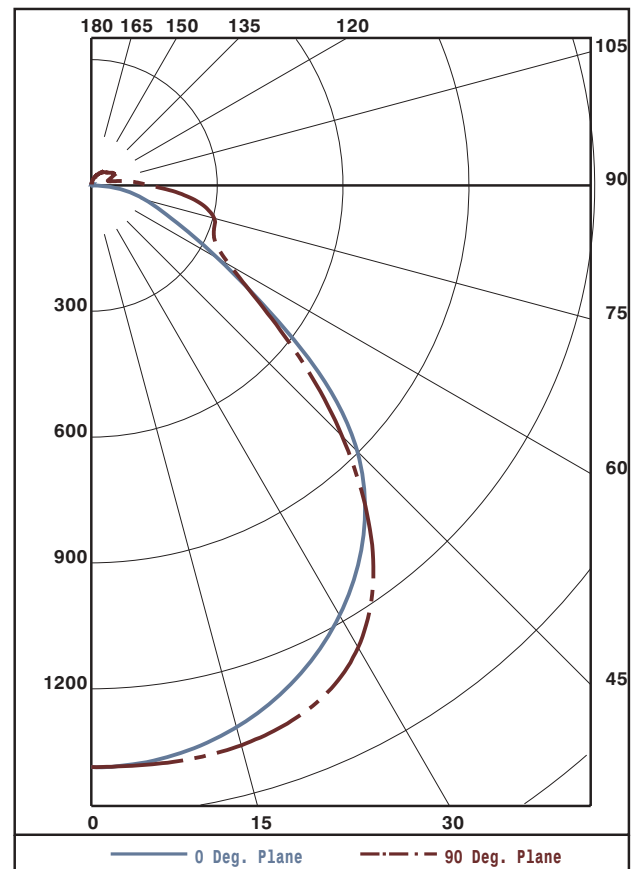

Approved By: MG



LUMINAIRE TESTING LABORATORY, INC.

SUSTAINING MEMBER of the IESNA

905 Harrison Street · Allentown, PA 18103 · 610-770-1044 · Fax 610-770-8912 · www.LuminaireTesting.com

LTL NUMBER: 13199

DATE: 08-04-2008

PREPARED FOR: EB FLUORESCENT COMPANY, INC.

COEFFICIENTS OF UTILIZATION - ZONAL CAVITY METHOD
EFFECTIVE FLOOR CAVITY REFLECTANCE 0.20

Table with columns for RC, RW, and various angles (80, 70, 50, 30, 10, 0) for rows 0 through 10.

PLANE: 0-DEG 90-DEG
LUMINOUS LENGTH: 48.000 8.875
HEIGHT OF SIDE: 0.000 1.500

LUMINANCE IN CANDELA PER SQUARE METER

Table with columns for ANGLE IN DEG, AVERAGE 0-DEG, AVERAGE 45-DEG, AVERAGE 90-DEG for angles 0, 45, 55, 65, 75, 85.



LUMINAIRE TESTING LABORATORY, INC.

SUSTAINING MEMBER of the IESNA

905 Harrison Street · Allentown, PA 18103 · 610-770-1044 · Fax 610-770-8912 · www.LuminaireTesting.com

LTL NUMBER: 13199
PREPARED FOR: EB FLUORESCENT COMPANY, INC.

DATE: 08-04-2008

CANDELA DISTRIBUTION

Table with 6 columns of candela values for various angles from 0 to 180 degrees.

ZONAL LUMEN SUMMARY

Table with 2 columns showing lumen values for various zones from 0-5 to 175-180 degrees.

THIS TEST WAS CONDUCTED USING RELATIVE PHOTOMETRY TECHNIQUES ACCORDING TO STANDARD IESNA PROCEDURES. THE USER MUST THEREFORE USE CAUTION IN THE FOLLOWING SITUATIONS: 1) THIS TEST WAS PERFORMED USING A SPECIFIC BALLAST/LAMP COMBINATION. EXTRAPOLATION OF THESE DATA FOR OTHER BALLAST/LAMP COMBINATIONS MAY PRODUCE ERRONEOUS RESULTS. 2) ACCORDING TO IESNA PROCEDURES, THE BALLAST(S) AND LAMP(S) ARE PRESUMED TO PRODUCE 100% OF RATED OUTPUT. AN APPROPRIATE BALLAST FACTOR MUST BE APPLIED TO THE LUMEN OUTPUT RATINGS AND LUMINOUS INTENSITY VALUES GIVEN. 3) THIS TEST WAS CONDUCTED IN A CONTROLLED LABORATORY ENVIRONMENT WHERE THE AMBIENT TEMPERATURE WAS HELD AT 25°C ±1°C. FIELD PERFORMANCE MAY DIFFER PARTICULARLY IN REGARDS TO CHANGE IN LUMINOUS OUTPUT AS A RESULT OF DIFFERENCE IN AMBIENT TEMPERATURE AND METHOD OF MOUNTING THE LUMINAIRE.